

Agricultural Products





Standard Features

- Viewing Windows
- LED Road Lights
- Front Ladder
- Unloading Door includes metering door
- Solid Welded Box Interior

Model	MK 3200		
Extension	N/A	8"	19"
Capacity (Bushels)	320	375	450
Hopper Construction	14 GA.		
Under Structure	3" x 6" x .188 wall rectangular tube		
Unloading Door	45' width		
Chute Height	17"-20"		
Box Dimensions			
Length	158"	158"	158"
Width	96"	96"	96"
Height (less wagon)	78"	86"	98"
Height (wagon & 22.5" wheel)	102"	110"	122"
Wheel Base	112"		

Gravity Box



Optional Equipment



- Horst Running Gear
- Center Dump Deflector
- Divider Kit
- Grain Shield Tarp Kit
- Hydraulic Door Opener
- Rear Ladder Kit

MK 5000			MK 6500		
N/A	8"	12"	N/A	8"	12"
500	570	605	645	745	800
12 GA.			12 GA.		
4" x 8" .188" wall rectangular tubing			4" x 8" .188" wall rectangular tubing		
57" width (standard) 28" width x2 (divider)			57" width (standard) 28" width x2 (divider)		
17"-21"			16"-20"		
196"	196"	196"	229"	229"	229"
101"	101"	101"	115"	115"	115"
89"	98"	101"	91"	99"	103"
123"	131"	135"	125"	133"	137"
	142"			156"	



1050 Grain Cart

Turn to your trusted harvest partner this year with MK Martin's lineup of Grain Carts. With capacities ranging from 650 to 1050 bushels, you can rest assured these Grain Carts are ready to take to the field when you are.

Each model features a hydraulic shield, covering the auger when not in operation allowing the auger to start empty. Not only does this save the drive system, it also gives you, the operator, full control over metering the unloading speed. Exclusive to the 1050 model, the auger is located on the right side allowing the operator to have both the auger and controls on the same side making it more operator friendly.

Featuring an unload time of 2 minutes and utilizing the hydraulic shield to retrieve the lost grain along with a clean-out hatch, not only can you quickly and easily unload the contents of your Grain Cart, but you can ensure you minimize the amount of wasted grain - meaning more profit for you and your business.

Optional Equipment

- Grain Shield Tarp Kit
- Digi-Star Scale Kit



1050 Grain Cart

Grain Cart



850 Grain Cart

Model	MK 650	MK 850	MK 1050
Capacity (Bushels)	650	850	1,050
Unload Time (Approx.)	2 mins	2 mins	2 mins
Auger (One Vertical)	16"	18"	22"
Auger Height	160"	160"	159"
Auger Chute Deflector	N/A	Hydraulic	Hydraulic
Auger Reach	66"	60"	50"
Weight (Approx.) (LBS.)	7,050	9,200	13,500
Tongue Weight (Empty) (LBS.)	1,000	1,000	3,000
Tongue Weight (Loaded) (LBS.)	3,400	3,400	4,300
PTO (RPM)	1,000	1,000	1,000
Hopper Material	12 GA. Steel	12 GA. Steel	12 GA. Steel
Undercarriage (Construction)	8" x 4" x 1/4" Tubing	8" x 4" x 5/16" Tubing	8" x 4" x 3/8" Tubing
Axle	5" x 5" x 1/2" Tubing	5" x 5" x 1/2" Tubing	5" x 5" x 1/2" Tubing
Tire Size (Ply)	800/65 R32	900/60 R32	1,050/50 R32
Hubs	10 Bolt	10 Bolt	10 Bolt
Rims	27 x 32	27 x 32	36 x 32
Spindles	5" diam.	5" diam.	6" diam.



Forage King - Bale Handler

The Forage King Bale Handler is constructed of 1 x 1 x 0.083w tubing giving it unmatched strength in its class. 1 sealed bearings on all shafts make it a low maintenance piece of equipment to care for.

Features

- 1" shafts that turn on sealed ball bearings
- 7-tooth cast sprockets on keyways
- No. 55 detachable link carrier chain
- Heavy, durable 1" square tubing overall
- Comes in sections so system bolts together in any configuration as required

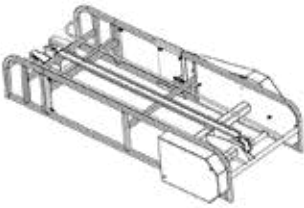

MB10 Basic Drive

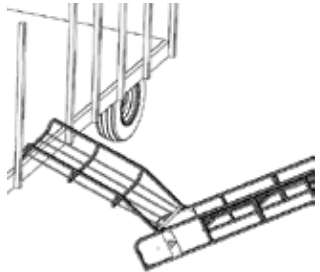

MBC Bale Chute

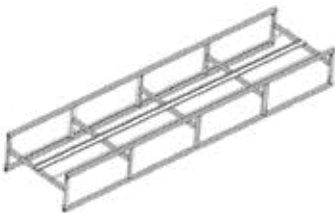

Center Sections

MC8
MC12

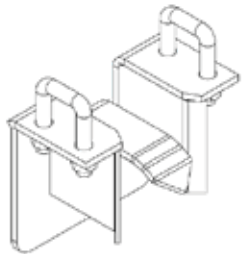

MSL Slide Chain Lifter

Implement Caddy



The Implement Caddy by MK Martin converts your 3PH implements to trailed versions when access to a 3PH equipped unit is not available. Hydraulically raise and lower caddy to desired height. This alternative to conventional 3PH mounting allows greater flexibility over your work force.

Model	SCIC250	SCIC1700
Width	125"	152"
MAX HP	250	500
Weight (LBS.)	3,560 **	7,750
Lift Cyl.	3-1/2 x 16	5 x 14
Lift Capacity (LBS.)	12,000	20,000
Category	CAT. 2 & 3	CAT. 4
Tires	12.5L	16.5 x 16.1



The Strip Cat is fully adjustable to your field conditions. Available in a 3PH or Trailed version the Strip Cat can be set up for either liquid or dry fertilizer application allowing an all in one tilling and fertilizing solution.

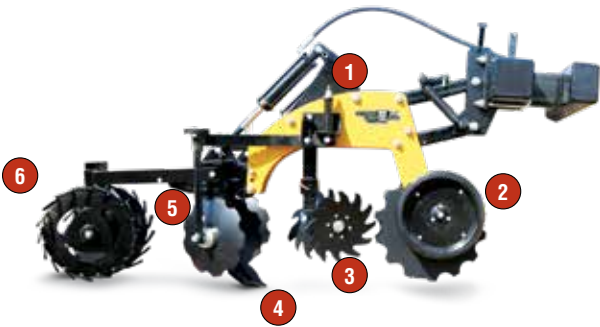

- | | |
|---|------------------------|
| 1 Hydraulic Reset | 4 Mole Knives |
| 2 Row Depth Control & Residue Sizing | 5 Berm Builders |
| 3 Sunco Trash Managers | 6 Pack Wheels |



Benefits

- Reduces field travel and compaction
- Improves fertilizer management
- Reduces soil erosion
- Increases germination

Features

- Choose from 4-6-8-12-16 Row Units
- Standard 30" Spacing (Optional 22" Spacing)
- Independent row units with adjustable down pressure
- Dry lube bushings in joints
- Adjustable IRD Depth wheels
- 20" notched coulters (30% more cutting)
- Sunco Trash Managers to clean the tilled strip
- Independent spring loaded berm builders (height and angle adjustment)
- Dual wheel packers with adjustable down pressure
- All pull pin adjustments

STRIP CAT ROW UNIT ORDER

Main Unit SCBRU 	Slitter Coultter A SCSNC B SCSWC 	Trash Manager Set SCSTM 	Knife Point A SCSTPO B SCLDPO
Floating Trash Manager Head ST-5011196 Blank if not required 	Fixed Knife Adaptor 22855 Not used with Hyd Tripper 	Knife Shank A SCKLSTS B SCKLSTL 	
Independent Berm Builder 1-SCNIBBD 2-SCNIBBC 	Packer/Berm Enhancer A SCBPT B SCBPW C SCBE 	Row Depth Gauge A SCIRD T B SCIRD L 	

STRIP CAT TOOLBAR

Hydraulic Knife SCHTA6R30 A 6-30 Row Hydraulic Knife Tripper SCHTA8R30 B 8-30 Row Hydraulic Knife Tripper SCHTA12R30 C 12-30 Row Hydraulic Knife Tripper SCHTA16R30 D 16-30 Row Hydraulic Knife Tripper SCHTA18R22 E 18-22 Row Hydraulic Knife Tripper	Gauge Wheel SCSGW A Standard Gauge Wheel Set SCPDGW B Pump-Drive Gauge Wheel Set SCLGW C Inside Gauge Wheel Winged Toolbar
--	--

Toolbar SCTB6R30 A 6 Row 30" c-c Toolbar SCTB8R30 B 8 Row 30" c-c Toolbar SCTBF12R30 12 Row 30" c-c Toolbar SCTBF16R30 16 Row 30" c-c Toolbar SCTBF18R22 18 Row 22" c-c Toolbar	Trailer Hitch SCTDF A Standard Trailer Hitch SCNTDF B Narrow Trailer Hitch
---	---

Model	Description	6 Row (30" Rigid)	8 Row (30" Rigid)	12 Row (30" Folding)	16 Row (30" Folding)	18 Row (22" Folding)
SCTB6R30	6 row 30" tool bar	1	-	-	-	-
SCTB8R30	8 row 30" tool bar	-	1	-	-	-
SCTBSF12R30	12 row 30" Stack N Fold	-	-	1	-	-
SCTB12R30	12 row 30" tool bar	-	-	1	-	-
SCTBSF16R30	16 row 30" Stack N Fold	-	-	-	1	-
SCTB16R30	16 row 30" tool bar	-	-	-	1	-
SCTB28R22	18 row 22" tool bar	-	-	-	-	1
SCBRU	Generation II row unit	6	8	12	16	18
SCSNC	Notched Coulter	6	8	12	16	18
SCSWC	Wavy Coulter	6	8	12	16	18
SCSTM	Sunco Trash Manager	6	8	12	16	18
ST5011196	Floating Trash Manager mnt	3	4	6	8	9
SCIRDT	Depth Gauge Wheel (set)	6	8	12	16	18
SCIRDC	Coulter Depth Gauge Wheel	6	8	12	16	18
22855	Fixed Knife Adaptor	6	8	12	16	18
SCNIBBD	Independent Berm Builder (cupped)	6	8	12	16	18
SCNIBBC	Independent Berm Builder (wavy)	6	8	12	16	18
SCBPT	Berm Packer (urethane)	6	8	12	16	18
SCBPW	Berm Packer (wire)	6	8	12	16	18
SCBE	Berm Enhancer	6	8	12	16	18
SKLSTS	Knife Shank w/repl. Standard Point (liquid)	6	8	12	16	18
SKDDTL	Knife Shank w/repl. Low Draft Point (liquid/dry)	6	8	12	16	18
SCCK10	10 degree knife coulter	6	8	12	16	18
SCCK15	15 degree knife coulter	6	8	12	16	18
SCHTA6R30	6 row 30" hydraulic tripper	1	-	-	-	-
SCHTA8R30	8 row 30" hydraulic tripper	-	1	-	-	-
SCHTASF12R30	12 row 30" hydraulic tripper (For Stack N Fold)	-	-	1	-	-
SCHTA12R30	12 row 30" hydraulic tripper	-	-	1	-	-
SCHTASF16R30	16 row 30" hydraulic tripper (For Stack N Fold)	-	-	-	1	-
SCHTA16R30	16 row 30" hydraulic tripper	-	-	-	1	-
SCHTA18R22	18 row 22" hydraulic tripper	-	-	-	-	1
SCSGW	Standard Gauge Wheel (set)	1	1	1	1	1
SCPDGW	Pump Drive Gauge Wheel (set)	1	1	1	1	1
SCTDF	Trailer Hitch	1	1	1	1	1
SCSTPO	Replacement knife point (mini Mole)(Parts)	6	8	12	16	18
SCLDPO	Replacement knife point (low draft)(Parts)	6	8	12	16	18



Stack N Fold Toolbar



The Stack N Fold Toolbar from MK Martin is designed to provide safe and easy transport of Strip Cat strip till systems. By stacking both end sections over the center section, the Stack N Fold Toolbar quickly reduces the overall width providing easier transport from field to field. The over centre design and locking pins ensure that the end sections remain securely in place during travel and when in storage.

Stack N Fold Toolbars can be configured with 2 to 4 remotes allowing you to control each side of the toolbar separately. This allows for easier service and maintenance, as well as for custom operations when you may not need the full width of the Strip Cat such as on headlands and point rows.



Features

- Available from 8-Row to 18-Row
- Allows for parallel horizontal stacking of row units
- Ideal for transport and storage
- Equipped with 2 large cylinders (5x30 fold cyl.)
- Equipped with 2 small cylinders (2x4)
- Requires 2 to 4 remotes depending on configuration

Disc Mower Implement Caddy



The MK Disc Mower Implement Caddy transforms your 3PH disc mower into a pull type unit to help reduce wear on the mower while reducing stress from your tractor. Using the adjustable top link, you can connect your disc mower faster and easier than before, and with the addition of the adjustable you can level your caddy and mower for an even cut as you drive along.

The MK Disc Mower Implement Caddy comes in two models: inline (C1201) and offset (C1200).

Model	MKC1200	MKC1201
Weight (LBS.)	1,900	1,835
Lift Cyl.	3x8	3x8
Tires	11L 15	11L 15
Main Frame	7x7 Tube	7x7 Tube
RPM	540	540
Driveline	#5	#5

Features

Adjustable Hitch



Hydraulic (Option)

